

Table with 6 columns: PART NUMBER, REV, FIRST USED, POWER UNIT, FEED TYPE, DESCRIPTION. Rows include parts like LEADMAKER, BENCH MODEL K, CONTINUOUS CARRIER.

- RECOMMENDED SPARE PARTS.
GREASE LIGHTLY.
GUARD MUST BE IN PLACE WHEN OPERATING APPLICATOR IN A BENCH MACHINE.
LUBRICATE DAILY USING NO. 20 MACHINE OIL.
ITEMS WITH QTY OF REF SPECIFIED (EXCEPT ITEMS 78 AND 79) ARE USED ON ITEM 46.
THIS APPLICATOR APPLIES TERMINAL WITH A SEAL.
APPLY TORQ-SEAL IN ALLEN SOCKET TO FILL HOLE AFTER FLAT HD HAS BEEN ADJUSTED TO CORRECT HEIGHT AT QUALIFICATION. APPLY PN 1-23419-5 LOC-TITE TO THREADS.

Terminal specification tables including AMP TERM PN, MFR TERM PN, PACKARD TERMINAL, CRIMP HEIGHT, WIRE SIZE, AMP SEAL PN, MFR SEAL PN, CRIMP SIZE, TYPE, RANGE, WIRE INSUL, WIRE STRIP LENGTH, TERM APPL SPEC, FEED, APPL INSTRUCTION, SET UP GAGE, LAYOUT.

Main parts list table with columns: QTY, REF, PART NO, DESCRIPTION, ITEM NO. Lists various components like pins, washers, screws, springs, and guides.

Large parts list table with columns: QTY, REF, PART NO, DESCRIPTION, ITEM NO. Includes items like NUT, HEX, PLATE, ADJUSTMENT, SHAFT, PIVOT, BUSHING, LEVER, INTERMEDIATE, BLOCK, PIVOT, SCREW, ADJ FEED ROD, PIN, CAM ROLLER, ROLLER, CAM, ROD, FEED, GUIDE, FEED ROD, CAP, RAM, HOUSING, PAWL, FEED, PIN, FEED FINGER, SPRING, FEED FINGER, HOLDER, FEED FINGER, LEVER, TERMINAL FEED ARM, BUMPER, HOLDDOWN, SPACER, TONKER, CAM, PRE-FEED 1 5/8 ST, CAM, PRE-FEED 1 1/8 ST, CAM, POST-FEED 1 5/8 ST, APPLICATOR, BASIC (SUBASSY), PLUG, NYLON, RAM, WASHER, LAMINATED, WASHER, RAM, BOLT, CRIMPER (5/16x1.00), BALL, STEEL, SPRING, COMPRESSION, DISC, INSULATION, WIRE DISC, PLASTIC, WASHER, SPRING, POST, RAM, SUPPORT, TERMINAL, PLATE, BASE, SCREW, ADJUSTMENT, BLOCK, STRIP GUIDE ADJ, PLATE, STRIP GUIDE, SPACER, FRONT SHEAR DEP, SPRING, DRAG, LEVER, DRAG RELEASE, DRAG, TERMINAL, GUIDE, STRIP (REAR), GUIDE, STRIP (FRONT), STRIPPER, SPRING, FEED RETURN, STRIPPER, HOLDER, SHEAR (NO CUT), GUARD, CHIP, FRONT, SPRING, SHEAR, STOP, SHEAR, HOLDER, SHEAR (FRONT), SHEAR, FLOAT (FRONT), ANVIL, SPACER, DEPRESSOR (REAR), DEPRESSOR, SHEAR (FRONT), SPACER, BLOCK CRIMPER, CRIMPER, INSULATION, SPACER, CRIMPER, CRIMPER, WIRE.

THIS DRAWING IS A CONTROLLED DOCUMENT.

20

RELEASED FOR PUBLICATION BY AMP INCORPORATED. ALL RIGHTS RESERVED. COPYRIGHT 20

LOC A, DIST 66

1385507 (vertical text on right edge)

Technical drawing footer containing dimensions, tolerances, revision record, and company information for AMP Tyco Electronics.

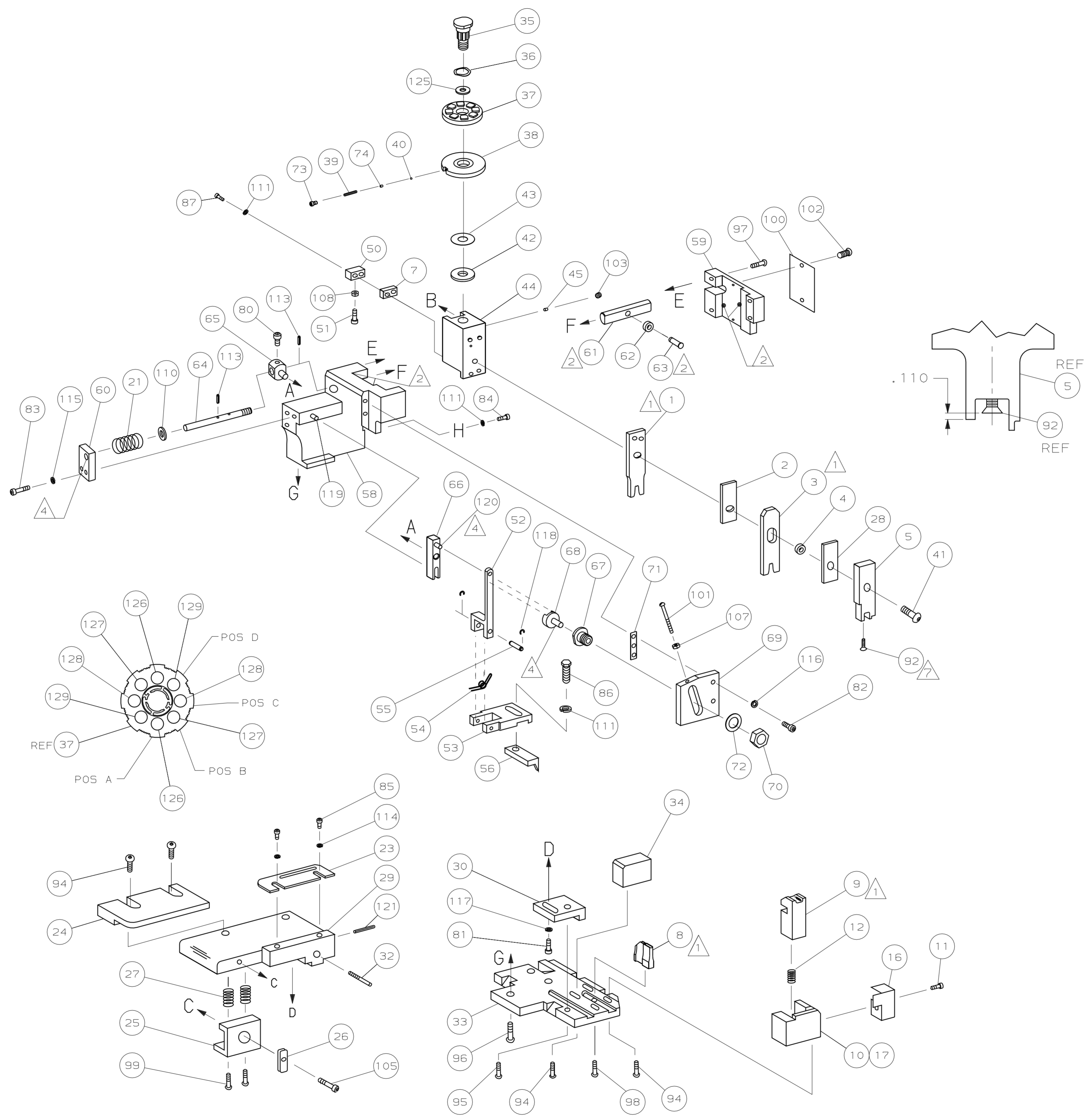
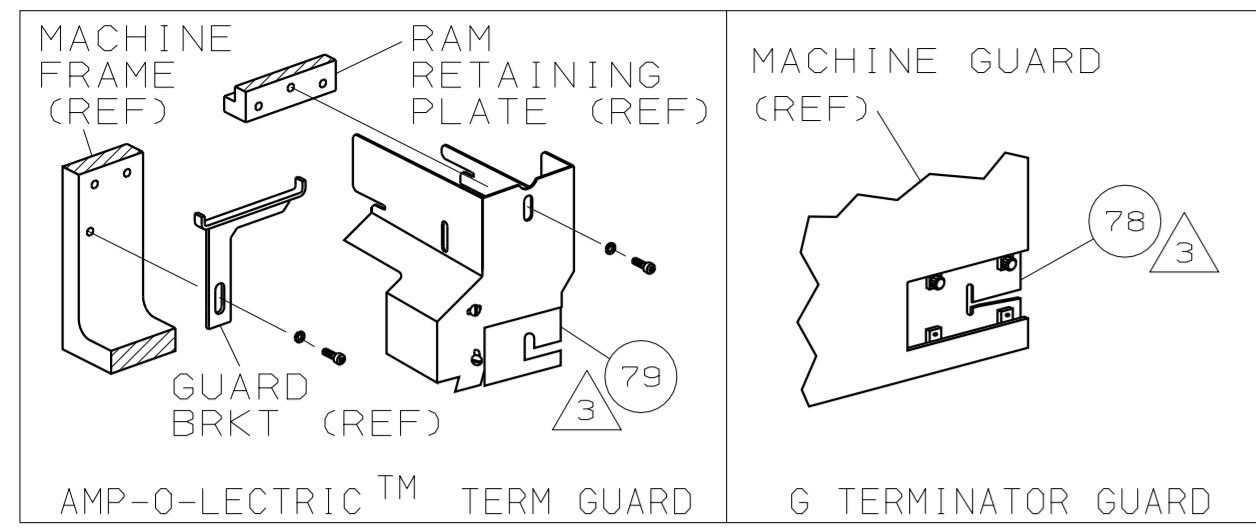

POST FEED 1 5/8 STROKE	PRE FEED 1 1/8 STROKE	PRE FEED 1 5/8 STROKE
ROTATED 180° B	ROTATED 180° B	ROTATED 180° B
LEADMAKER	K TERMINATOR	G TERMINATOR

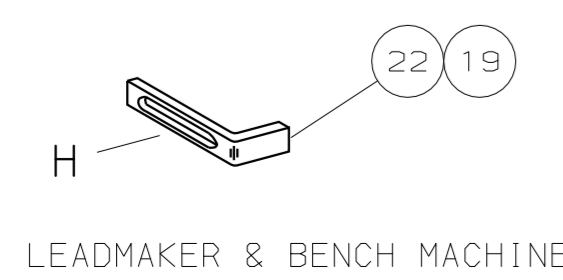

DWG SIZE	PART NO	DESCRIPTION	ITEM NO
REVISION OF EACH ASSY NO (WHEN BLANK, USE DWG REVISION)			
QTY REQD PER ASSY		PARTS LIST	
MATL	HT TR	FIN	
DIMENSIONS IN INCHES. DO NOT SCALE PRINT.			
TOLERANCES UNLESS OTHERWISE SPECIFIED:			
DR	20DEC06	APP	21DEC06
R.O.WILSON		T.BENCHOFF	
2	PLC DEC ±	REL	-
3	PLC DEC ±		
4	PLC DEC ±		
ANGLES ± -			
SURF TEXTURE: ✓			
REMOVE BURRS, BREAK SHARP EDGES R.015 MAX			
SCALE	DWG NO	1385507	SHEET 2 OF 2
CAGE CODE 00779		CUSTOMER AND ASSEMBLY DRAWING	RESTRICTED TO

SEE SHEET 1
REVISION RECORD
APP
DATE

THIS DRAWING IS A CONTROLLED DOCUMENT.

.20

THIS DRAWING IS UNPUBLISHED.
RELEASED FOR PUBLICATION
BY AMP INCORPORATED. ALL RIGHTS RESERVED.
COPYRIGHT 20

LOC
A
DIST
66

1385507

D

C

B

A



ООО «НИОКРсистемс» - это оперативные поставки широкого спектра электронных компонентов отечественного и импортного производства напрямую от производителей и с крупнейших мировых складов. Реализуемая нашей компанией продукция насчитывает более полумиллиона наименований.

Благодаря этому наша компания предлагает к поставке практически не ограниченный ассортимент компонентов как оптовыми, мелкооптовыми партиями, так и в розницу.

Благодаря развитой сети поставщиков, помогаем в поиске и приобретении экзотичных или снятых с производства компонентов.

Наша компания это:

- Гарантия качества поставляемой продукции
- Широкий ассортимент
- Минимальные сроки поставок
- Техническая поддержка
- Подбор комплектации
- Индивидуальный подход
- Гибкое ценообразование
- Работаем по 275 ФЗ